



**Features (特长)**

- Magnetically shielded construction (闭磁路构造设计)
- Compact and thin (轻便薄小)
- Large Current and Low DCR (大电流低直流阻抗)

**Applications (用途)**

- Ideal for a variety of DC/DC converter inductor applications. (各种直流转换器适用)
- Scanner (扫描器)

**Product Identification (产品识别)**

SDR52 - \_\_\_\_\_ (Ex. SDR52-100M)

1          2          3

1. SMT Shielded Power Inductors (闭磁式功率电感)  
( SDR52 / SDR62)
2. Inductance (电感值)
3. Tolerance (误差值) ( 参照表 K:10%, L:15%, M:20%, N:30% )

**Configurations & Dimensions**

(结构图及规格尺寸)

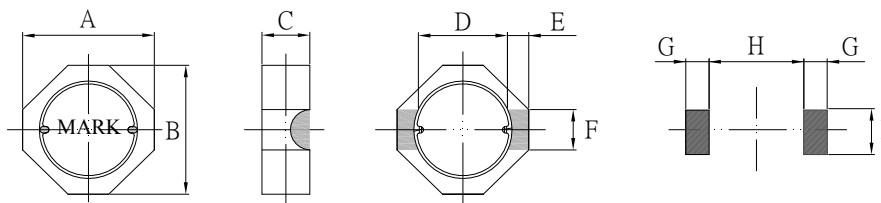

Unit In: mm

Type	A(max)	B(max)	C(max)	D(Ref.)	E	F	G	H	I
SDR52	5.8	5.5	2.0	3.9	0.65	1.8	1.1	3.7	2.0

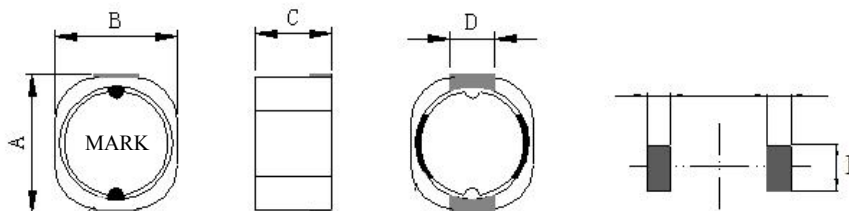

Unit In: mm

Type	A(max)	B(max)	C(max)	D(Ref.)	E	F	G
SDR62	6.9	6.2	2.5	2.0	1.0	1.0	2.6

♣Design as Customer' s Requested Specifications. (可依客户特殊需求设计)

## SDR52 / SDR62

Codes	L ( $\mu$ H)	Tolerance	Test Freq. (KHz)	DCR ( $\Omega$ ) max		IDC (A) max	
				52	62	52	62
1R0	1.0	N	100	-	0.029	-	3.60
1R5	1.5	N	100	-	0.034	-	3.15
2R2	2.2	N	100	0.052	0.046	2.00	2.20
3R3	3.3	N	100	0.081	0.049	1.60	2.00
4R7	4.7	N	100	0.116	0.072	1.50	1.60
6R8	6.8	N	100	0.130	0.080	1.15	1.40
100	10.0	M	100	0.191	0.127	0.750	1.20
150	15.0	M	100	-	0.195	-	0.95
220	22.0	M	100	0.403	0.276	0.500	0.77
330	33.0	M	100	0.702	0.398	0.400	0.64
470	47.0	M	100	0.715	0.605	0.400	0.50
101	100.0	M	100	1.60	1.20	0.370	0.32
121	120.0	M	100	-	1.70	-	0.30
151	150.0	M	100	2.40	2.30	0.310	0.26
221	220.0	M	100	3.60	-	0.260	-
331	330.0	M	100	6.00	4.60	0.130	0.17
471	470.0	M	100	8.60	5.90	0.100	0.14

※Test Freq. : 100KHz /0.1V.

※Operating Temp. :  $-40^{\circ}\text{C} \sim +105^{\circ}\text{C}$

※Inductance drop = 35% typ. at Isat.